

Green Pin® Eyebolts

metric coarse thread, generally to DIN 580

Material: Carbon steel, C15
Safety Factor: MBL equals 4 x SWL
Standard: Generally to DIN 580
Finish: Self colour
Certificate: This product is supplied with an EC declaration of conformity

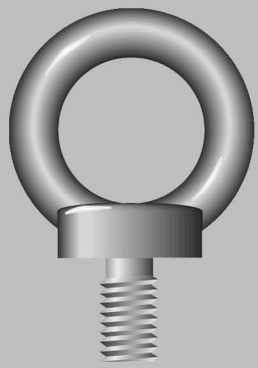

working load limit	diameter thread	diameter base	diameter eye outside	diameter eye inside	length	thickness base	height	product code	weight per 100 pcs
tonnes	a mm	b mm	c mm	d mm	e mm	f mm	g mm		kg
0.07	6	20	36	20	13	6	36	25001	6.00
* 0.14	8	20	36	20	13	6	36	25002	6.00
0.23	10	25	45	25	17	8	45	25003	10.30
0.34	12	30	54	30	20.5	10	53	25004	17.70
0.49	14	35	63	35	27	12	60	25005	27.70
* 0.70	16	35	63	35	27	12	62	25006	28.00
0.90	18	40	72	40	30	14	71	25007	40.50
* 1.20	20	40	72	40	30	14	71	25008	42.40
1.50	22	45	81	45	35	14	80	25009	67.30
* 1.80	24	50	90	50	36	18	90	25010	83.40
2.50	27	50	90	50	36	18	90	25011	122.00
* 3.20	30	65	108	60	45	22	109	25012	166.00
4.30	33	65	108	60	45	22	110	25013	216.00
* 4.60	36	75	126	70	54	26	128	25014	265.00
6.10	39	75	126	70	54	26	130	25015	334.00
* 6.30	42	85	144	80	63	30	147	25016	403.00
8.00	45	85	144	80	63	30	150	25017	521.00
* 8.60	48	100	166	90	68	35	168	25018	632.00
11.50	56	110	184	100	78	38	187	25019	880.00
16.00	64	120	206	110	90	42	208	25020	1240.00

sizes marked * are additional and proportional to the specification

